

5 Gate Arm 120V. Source

New 3/4" 120V. Feed 20AMP.
18" Deep Trench Typical Approx. 60'

Existing 3/4" Electrical Conduit

Old Gate Arm Electrical Box

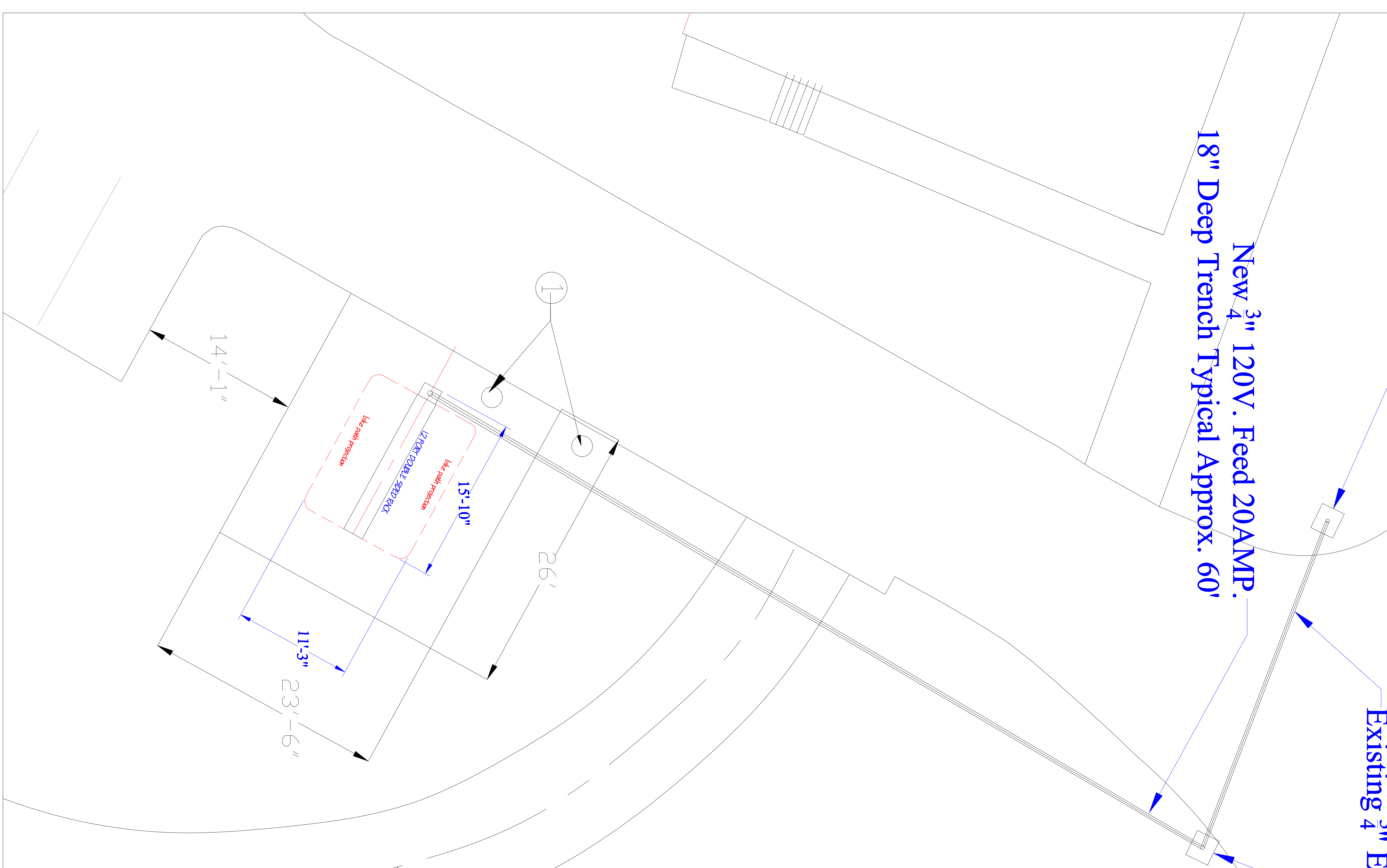

REMOVE FOR PAD

1) 2 YELLOW BALLARDS

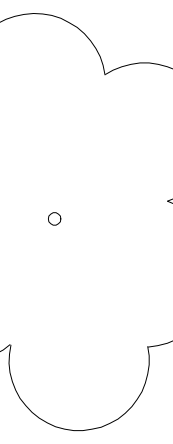
2)  = SYCAMORE/PINE

3) BUSH/SHRUB

4) Bike rack shall be centered in the pad.
giving 5' between the concrete edge and bike projections.

PROPOSED BIKE PATH

Conduit Location

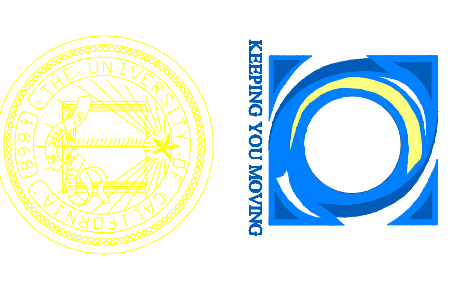
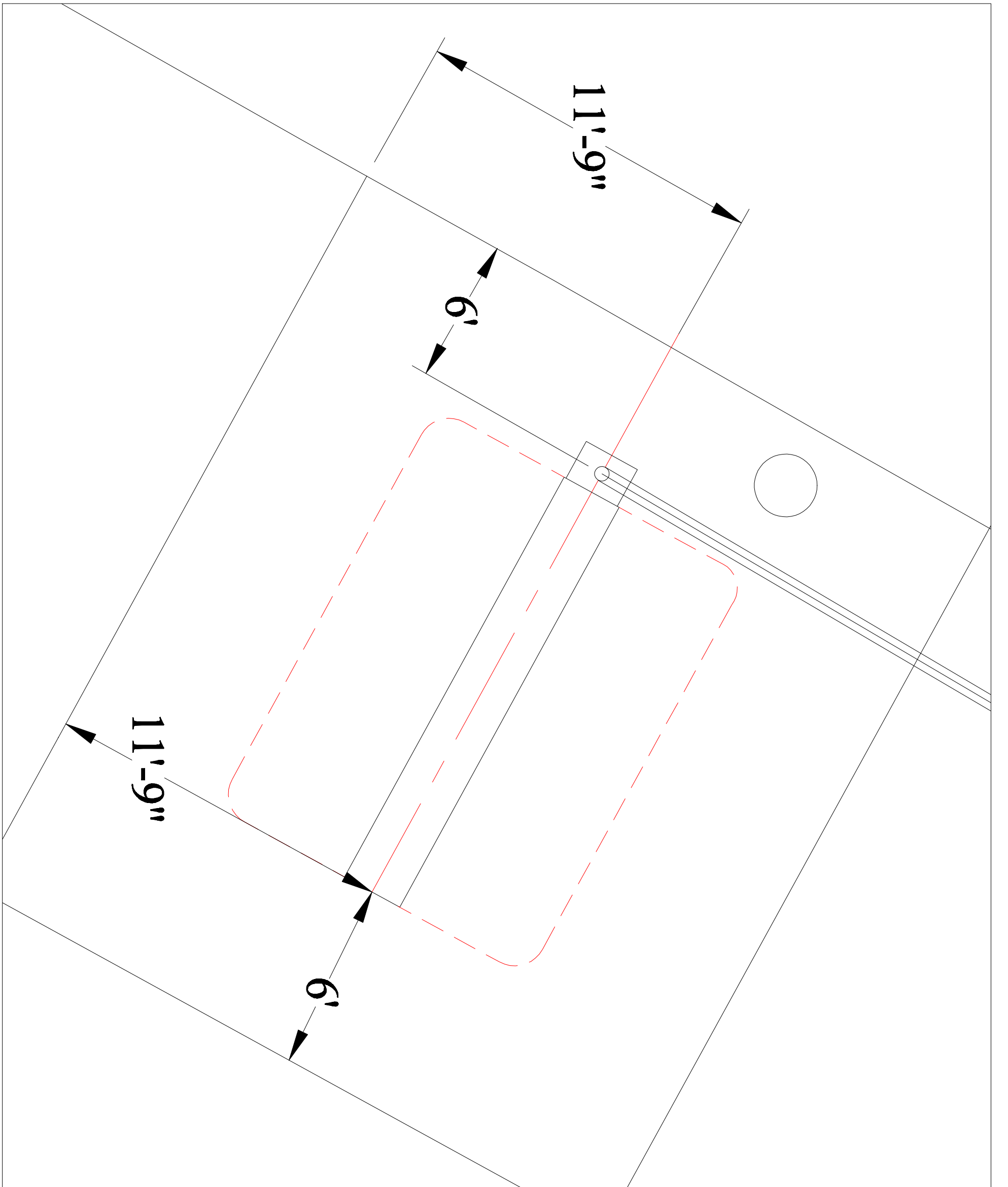

NO.	DATE	COMMENTS

DRAWN BY: Nicolas Arias
 DRAWN BY:
 DRAWN BY:
 CHECKED BY:
 CHECKED BY:

Bike Rack

Site 3 Pad Relocation

DATE CREATED: July 2nd 2009 UPDATED:
 SCALE: 1 PLOTTED: